

E-09

GENERATOR

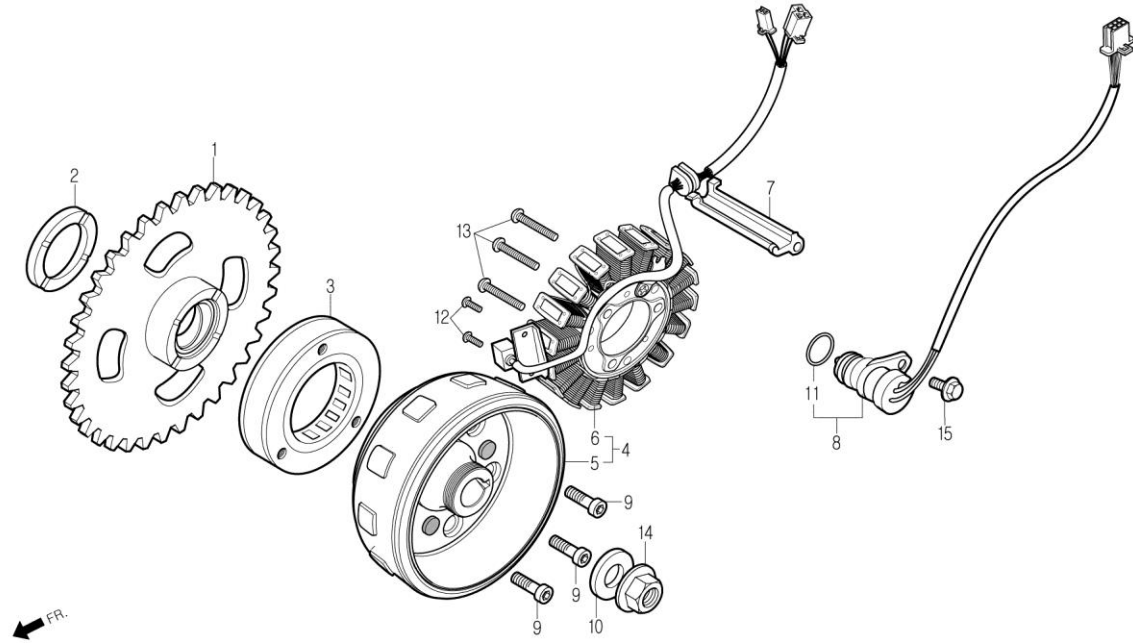

Service item	FRT	Ref No.	Part No.	Description	QTY	A/S	Exch	Start Date	End Date	Start FRM.No	End FRM.No
GEAR COMP., STARTER DRIVEN	0.8	1	28110-BA6-9610	GEAR COMP., STARTER DRIVEN	1	Y		20070425		KMYBA8BLS7C000001	
ONE WAY CLUTCH ASS'Y, STARTER · FLYWHEEL COMP	0.8	2	28114-BA6-9300	COLLAR, STARTER DRIVEN GEAR	1	N	Y	20070425	20070517	KMYBA8BLS7C000001	KMYBA8BLS7C000454
			28114-BA8-0000	COLLAR, STARTER DRIVEN GEAR	1	Y		20070518		KMYBA8BLS7C000455	
STATOR COMP.	0.7	3	28120-BA6-0050	ONE WAY CLUTCH ASS'Y, STARTER	1	N	Y	20070425	20160831	KMYBA8BLS7C000001	KMYBA8BLSHC005734
			2812A-BA6-0000-M1	CLUTCH ASS'Y, STARTER ONEWAY	1	Y		20160901		KMYBA8BLSHC005735	
SWITCH ASS'Y, CHANGE	0.3	4	31100-BA8-0000	GENERATOR ASS'Y, AC.	1	N	Y	20070425	20160831	KMYBA8BLS7C000001	KMYBA8BLSHC005734
			31100-BA8-0010	GENERATER ASS'Y, A.C.	1	Y		20160901		KMYBA8BLSHC005735	
		5	31110-BA8-0000	FLYWHEEL COMP.	1	N		20070425		KMYBA8BLS7C000001	
		6	31120-BA8-0000	STATOR COMP.	1	N	Y	20070425	20160831	KMYBA8BLS7C000001	KMYBA8BLSHC005734
			31120-BA8-0010	STATOR COMP.	1	Y		20160901		KMYBA8BLSHC005735	
		7	32976-BA6-9600	GUIDE, AC.GENERATOR CORD	1	Y		20070425		KMYBA8BLS7C000001	
		8	35759-BA1-1000	SWITCH ASS'Y, CHANGE	1	N	Y	20070425	20160404	KMYBA8BLS7C000001	KMYBA8BLSHC005636
			35759-BA1-1000-M1	SWITCH ASS'Y, CHANGE	1	Y		20160405		KMYBA8BLSHC005637	
		9	90010-BA6-0000	BOLT, SOCKET, 8x18	3	Y		20070425		KMYBA8BLS7C000001	
		10	90404-BA8-0000	WASHER, 12x30	1	Y		20070425		KMYBA8BLS7C000001	
		11	91305-BA6-0030	O-RING, 16.5x2.5	1	N		20070425		KMYBA8BLS7C000001	
		12	S3500-05016-0A	SCREW, PAN, 5x16	2	Y	Y	20070425	20070630	KMYBA8BLS7C000001	KMYBA8BLS8C001971
			S3500-05016-0H	SCREW, PAN, 5x16	2	N	Y	20070701	20100430	KMYBA8BLS8C001972	KMYBA8BLSAC003562
			S3500-05016-0A	SCREW, PAN, 5x16	2	Y		20100501		KMYBA8BLSAC003563	
		13	S3500-05032-0A	SCREW, PAN, 5x32	3	Y		20070425		KMYBA8BLS7C000001	
		14	S4050-12080	NUT, FLANGE, 12mm	1	Y		20070425		KMYBA8BLS7C000001	
		15	S6001-06014-00	BOLT, FLANGE, SH.6x14	1	Y		20070425		KMYBA8BLS7C000001	