

F-19

BATTERY

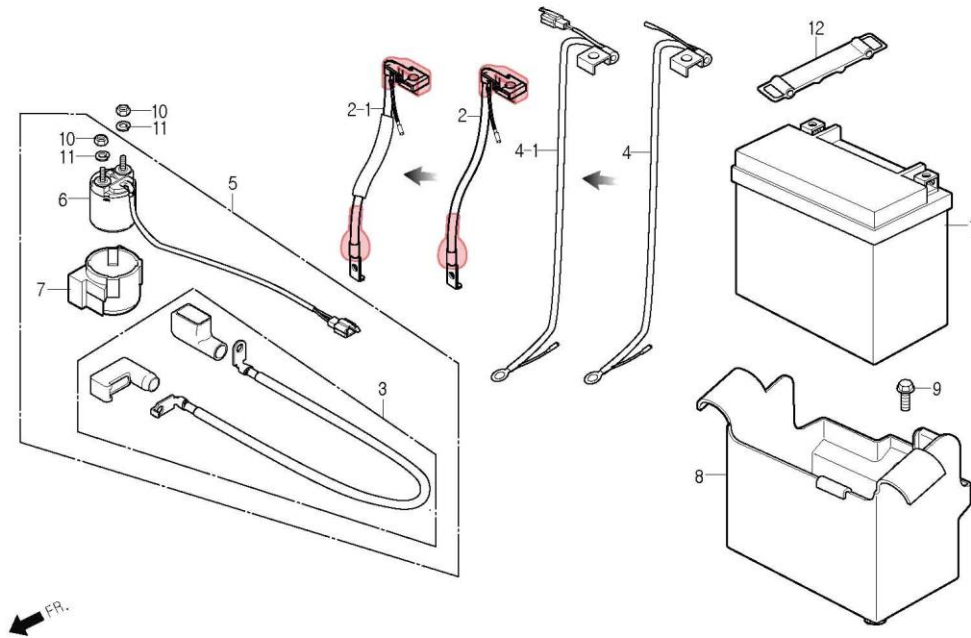

Service item	FRT	Ref No.	Part No.	Description	QTY	A/S	Exch	Start Date	End Date	Start FRM.No	End FRM.No
BATTERY 12V 10AH	0.3	1	31500-BA4-0000-M1	BATTERY, 12V 10AH(MF)	1	Y		20070425		KMYBA8BLS7C000001	
		2	32401-BA4-0000	CABLE,START MAG.BATTERY(+)	1	N	Y	20070425	20091109	KMYBA8BLS7C000001	KMYBA8BLSAC003417
SWITCH ASS'Y, START MAGNETIC	0.3	2-1	32401-BA4-0010	CABLE,START MAG.BATTERY(+)	1	Y		20091110		KMYBA8BLSAC003418	
· CABLE, START MAGNETIC BATTERY		3	32410-BA4-0000	CABLE, START MOTOR	1	N		20070425		KMYBA8BLS7C000001	
· CABLE, START MOTOR		4	32601-BA8-0000	CABLE, BATTERY EARTH	1	N	Y	20070425	20100831	KMYBA8BLS7C000001	KMYBA8BLSBC003814
		4-1	32601-BZ1-0000	CABLE, BATTERY EARTH	1	Y		20100901		KMYBA8BLSBC003815	
		5	3585A-BA4-0000	SWITCH SET, START MAGNETIC	1	Y		20070425		KMYBA8BLS7C000001	
		6	35850-SA1-0000	SWITCH ASS'Y, START MAGNETIC	1	N		20070425		KMYBA8BLS7C000001	
		7	35856-BA6-8300	SHOCK RUBBER, MAGNETIC	1	N		20070425		KMYBA8BLS7C000001	
		8	50320-BA4-0000	BOX, BATTERY	1	Y		20070425		KMYBA8BLS7C000001	
		9	90111-SE5-1000	BOLT, FLANGE, 6mm	1	Y		20070425		KMYBA8BLS7C000001	
		10	S4002-06080-0S	NUT, HEX, 6mm(Y)	2	Y		20070425		KMYBA8BLS7C000001	
		11	S4111-06800	WASHER, SPRING, 6mm	2	Y		20070425		KMYBA8BLS7C000001	
		12	S5012-15001	BAND D, BATTERY	1	Y		20070425		KMYBA8BLS7C000001	