

F-33

SIDE COWL

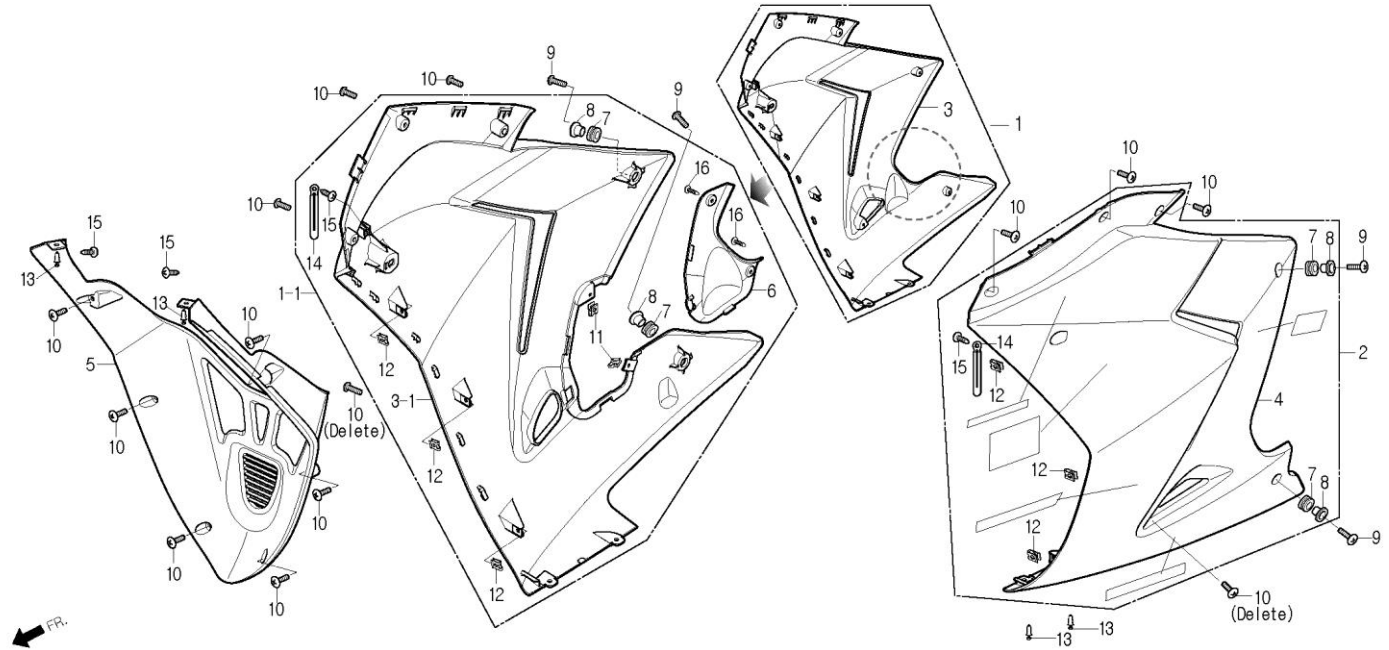

Service item	FRT	Ref No.	Part No.	Description	QTY	A/S	Exch	Start Date	End Date	Start FRM.No	End FRM.No
COWL ASS'Y, RH.SIDE	0.2	1	6430A-BA8-RE00-GB	COWL ASS'Y, RH.SIDEG/BLUE):France	1	N	Y	20070515	20080306	KMYBA8BLS7C000358	KMYBA8BLS8C002342
		1-1	6430A-BA8-RE10-GB	COWL ASS'Y, RH.SIDEG/BLUE)	1	Y	N	20080307	20110630	KMYBA8BLS8C002343	KMYBA8BLS8C004032
COWL ASS'Y, LH.SIDE	0.2		6430A-BA8-RE20-GB	COWL ASS'Y, RH.SIDEG/BLUE)	1	Y		20110701		KMYBA8BLS8C004033	
		1	6430A-BA8-RE00-IB	COWL ASS'Y, RH.SIDE(I/BLUE):France	1	N	Y	20070515	20080306	KMYBA8BLS7C000358	KMYBA8BLS8C002342
		1-1	6430A-BA8-RE10-IB	COWL ASS'Y, RH.SIDE(I/BLUE)	1	Y	N	20080307	20110630	KMYBA8BLS8C002343	KMYBA8BLS8C004032
		1	6430A-BA8-RE00-LR	COWL ASS'Y, RH.SIDE(L/RED):France	1	N	Y	20070515	20080306	KMYBA8BLS7C000358	KMYBA8BLS8C002342
		1-1	6430A-BA8-RE10-LR	COWL ASS'Y, RH.SIDE(L/RED)	1	Y	N	20080307	20110630	KMYBA8BLS8C002343	KMYBA8BLS8C004032
			6430A-BA8-RE20-LR	COWL ASS'Y, RH.SIDE(L/RED)	1	Y		20110701		KMYBA8BLS8C004033	
		1	6430A-BA8-RE00-WP	COWL ASS'Y, RH.SIDE(P/WHITE):France	1	N	Y	20070515	20080306	KMYBA8BLS7C000358	KMYBA8BLS8C002342
		1-1	6430A-BA8-RE10-WP	COWL ASS'Y, RH.SIDE(P/WHITE)	1	Y	N	20080307	20110630	KMYBA8BLS8C002343	KMYBA8BLS8C004032
			6430A-BA8-RE20-WP	COWL ASS'Y, RH.SIDE(P/WHITE)	1	Y		20110701		KMYBA8BLS8C004033	
		1	6430A-BA8-RZ00-GB	COWL ASS'Y, RH.SIDE(G/BLUE)	1	N	Y	20070425	20080306	KMYBA8BLS7C000001	KMYBA8BLS8C002342
		1-1	6430A-BA8-RZ10-GB	COWL ASS'Y, RH.SIDE(G/BLUE)	1	Y	N	20080307	20110630	KMYBA8BLS8C002343	KMYBA8BLS8C004032
			6430A-BA8-RZ20-GB	COWL ASS'Y, RH.SIDE(G/BLUE)	1	Y		20110701		KMYBA8BLS8C004033	
		1	6430A-BA8-RZ00-IB	COWL ASS'Y, RH.SIDE(I/BLUE)	1	N	Y	20070425	20080306	KMYBA8BLS7C000001	KMYBA8BLS8C002342
		1-1	6430A-BA8-RZ10-IB	COWL ASS'Y, RH.SIDE(I/BLUE)	1	Y		20080307	20110630	KMYBA8BLS8C002343	KMYBA8BLS8C004032
		1	6430A-BA8-RZ00-LR	COWL ASS'Y, RH.SIDE(L/RED)	1	N	Y	20070425	20080306	KMYBA8BLS7C000001	KMYBA8BLS8C002342
		1-1	6430A-BA8-RZ10-LR	COWL ASS'Y, RH.SIDE(L/RED)	1	Y	N	20080307	20110630	KMYBA8BLS8C002343	KMYBA8BLS8C004032
			6430A-BA8-RZ20-LR	COWL ASS'Y, RH.SIDE(L/RED)	1	Y		20110701		KMYBA8BLS8C004033	
		1	6430A-BA8-RZ00-WP	COWL ASS'Y, RH.SIDE(P/WHITE)	1	N	Y	20070425	20080306	KMYBA8BLS7C000001	KMYBA8BLS8C002342
		1-1	6430A-BA8-RZ10-WP	COWL ASS'Y, RH.SIDE(P/WHITE)	1	Y	N	20080307	20110630	KMYBA8BLS8C002343	KMYBA8BLS8C004032
			6430A-BA8-RZ20-WP	COWL ASS'Y, RH.SIDE(P/WHITE)	1	Y		20110701		KMYBA8BLS8C004033	
		1	6430A-BA8-0020-GB	COWL ASS'Y, RH.SIDE(G/BLUE)	1	Y		20100329	20110630	KMYBA8BLSAC003429	KMYBA8BLS8C004032
			6430A-BA8-0020-TY	COWL ASS'Y, RH.SIDE(T/GRAY)	1	Y		20100329	20110630	KMYBA8BLSAC003429	KMYBA8BLS8C004032

F-33

SIDE COWL

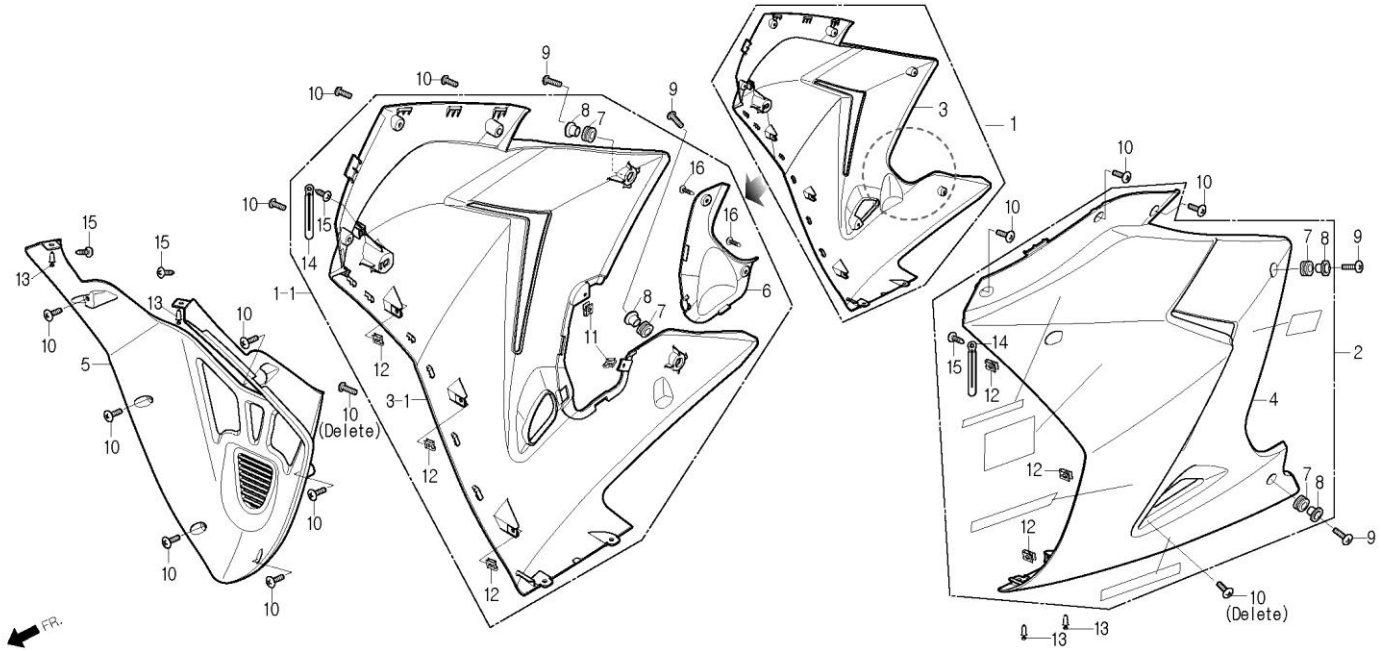

Service item	FRT	Ref No.	Part No.	Description	QTY	A/S	Exch	Start Date	End Date	Start FRM.No	End FRM.No
		2	6430A-BA8-0020-WP	COWL ASS'Y, RH SIDE(P/WHITE)	1	Y		20100329	20110630	KMYBA8BLSAC003429	KMYBA8BLSCC004032
			6430B-BA8-RZ00-GB	COWL ASS'Y, LH.SIDE(G/BLUE)	1	Y	N	20070425	20110630	KMYBA8BLS7C000001	KMYBA8BLSCC004032
			6430B-BA8-RZ10-GB	COWL ASS'Y, LH. SIDE(G/BLUE)	1	Y		20110701		KMYBA8BLSCC004033	
			6430B-BA8-RZ00-IB	COWL ASS'Y, LH.SIDE(I/BLUE)	1	Y		20070425	20110630	KMYBA8BLS7C000001	KMYBA8BLSCC004032
			6430B-BA8-RZ00-LR	COWL ASS'Y, LH.SIDE(L/RED)	1	Y	N	20070425	20110630	KMYBA8BLS7C000001	KMYBA8BLSCC004032
			6430B-BA8-RZ10-LR	COWL ASS'Y, LH. SIDE(L/RED)	1	Y		20110701		KMYBA8BLSCC004033	
			6430B-BA8-RZ00-WP	COWL ASS'Y, LH.SIDE(P/WHITE)	1	Y	N	20070425	20110630	KMYBA8BLS7C000001	KMYBA8BLSCC004032
			6430B-BA8-RZ10-WP	COWL ASS'Y, LH. SIDE(P/WHITE)	1	Y		20110701		KMYBA8BLSCC004033	
			6430B-BA8-RE00-GB	COWL ASS'Y, LH.SIDE(G.BLUE):France	1	Y	N	20070515	20110630	KMYBA8BLS7C000358	KMYBA8BLSCC004032
			6430B-BA8-RE10-GB	COWL ASS'Y, LH.SIDE(G.BLUE)	1	Y		20110701		KMYBA8BLSCC004033	
			6430B-BA8-RE00-IB	COWL ASS'Y, LH.SIDE(I/BLUE):France	1	Y		20070515	20110630	KMYBA8BLS7C000358	KMYBA8BLSCC004032
			6430B-BA8-RE00-LR	COWL ASS'Y, LH.SIDE(L/RED):France	1	Y	N	20070515	20110630	KMYBA8BLS7C000358	KMYBA8BLSCC004032
			6430B-BA8-RE10-LR	COWL ASS'Y, LH.SIDE(L/RED)	1	Y		20110701		KMYBA8BLSCC004033	
			6430B-BA8-RE00-WP	COWL ASS'Y, LH.SIDE(P/WHITE):France	1	Y	N	20070515	20110630	KMYBA8BLS7C000358	KMYBA8BLSCC004032
			6430B-BA8-RE10-WP	COWL ASS'Y, LH.SIDE(P/WHITE)	1	Y		20110701		KMYBA8BLSCC004033	
			6430B-BA8-0010-GB	COWL ASS'Y, LH SIDE(G/BLUE)	1	Y		20100329	20110630	KMYBA8BLSAC003429	KMYBA8BLSCC004032
			6430B-BA8-0010-TY	COWL ASS'Y, LH SIDE(T/GRAY)	1	Y		20100329	20110630	KMYBA8BLSAC003429	KMYBA8BLSCC004032
			6430B-BA8-0010-WP	COWL ASS'Y, LH SIDE(P/WHITE)	1	Y		20100329	20110630	KMYBA8BLSAC003429	KMYBA8BLSCC004032
		3	64301-BA8-0000-GB	COWL, RH.SIDE(G/BLUE)	1	N	N	20070425	20080306	KMYBA8BLS7C000001	KMYBA8BLS8C002342
		3-1	64301-BA8-0010-GB	COWL, RH.SIDE(G/BLUE)	1	N		20080307		KMYBA8BLS8C002343	
		3	64301-BA8-0000-IB	COWL, RH.SIDE(I/BLUE)	1	N	N	20070425	20080306	KMYBA8BLS7C000001	KMYBA8BLS8C002342
		3-1	64301-BA8-0010-IB	COWL, RH.SIDE(I/BLUE)	1	N		20080307	20110630	KMYBA8BLS8C002343	KMYBA8BLSCC004032
		3	64301-BA8-0000-LR	COWL, RH.SIDE(L/RED)	1	N	N	20070425	20080306	KMYBA8BLS7C000001	KMYBA8BLS8C002342
		3-1	64301-BA8-0010-LR	COWL, RH.SIDE(L/RED)	1	N		20080307		KMYBA8BLS8C002343	

F-33

SIDE COWL

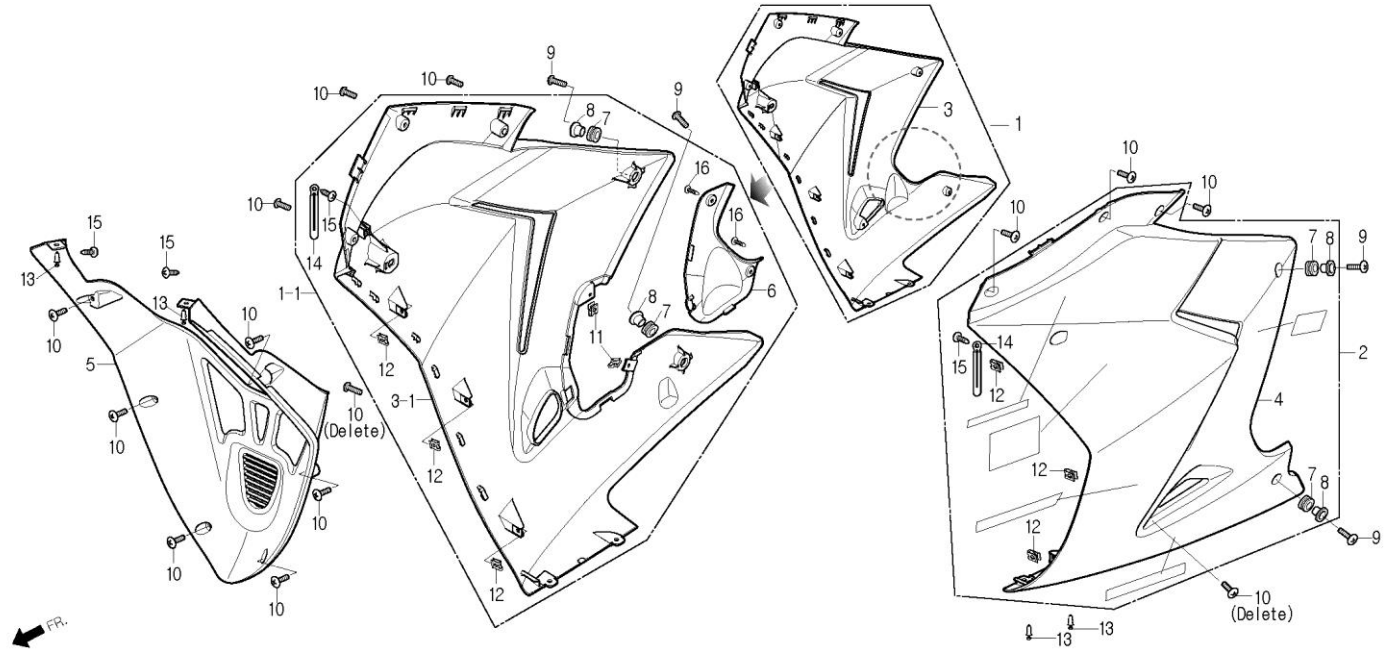

Service item	FRT	Ref No.	Part No.	Description	QTY	A/S	Exch	Start Date	End Date	Start FRM.No	End FRM.No
		3	64301-BA8-0000-WP	COWL, RH.SIDE(P/WHITE)	1	N	N	20070425	20080306	KMYBA8BLS7C000001	KMYBA8BLS8C002342
		3-1	64301-BA8-0010-WP	COWL, RH.SIDE(P/WHITE)	1	N		20080307		KMYBA8BLS8C002343	
		4	64302-BA8-0000-GB	COWL, LH.SIDE(G/BLUE)	1	N		20070425		KMYBA8BLS7C000001	
			64302-BA8-0000-IB	COWL, LH.SIDE(I/BLUE)	1	N		20070425	20110630	KMYBA8BLS7C000001	KMYBA8BLS8C004032
			64302-BA8-0000-LR	COWL, LH.SIDE(L/RED)	1	N		20070425		KMYBA8BLS7C000001	
			64302-BA8-0000-WP	COWL, LH.SIDE(P/WHITE)	1	N		20070425		KMYBA8BLS7C000001	
		5	64303-BA8-0000-GB	COWL, CENTER(G/BLUE)	1	Y		20070425		KMYBA8BLS7C000001	
			64303-BA8-0000-IB	COWL, CENTER(I/BLUE)	1	Y		20070425	20110630	KMYBA8BLS7C000001	KMYBA8BLS8C004032
			64303-BA8-0000-LR	COWL, CENTER(L/RED)	1	Y		20070425		KMYBA8BLS7C000001	
			64303-BA8-0000-WP	COWL, CENTER(P/WHITE)	1	Y		20070425		KMYBA8BLS7C000001	
		6	64304-BA8-0000-LR	COVER, OIL FILTER MAINT(L/RED)	1	Y		20080307		KMYBA8BLS8C002343	
			64304-BA8-0000-GB	COVER, OIL FILTER MAINT(G/BLUE)	1	Y		20080307		KMYBA8BLS8C002343	
			64304-BA8-0000-WP	COVER, OIL FILTER MAINT(P/WHITE)	1	Y		20080307		KMYBA8BLS8C002343	
			64304-BA8-0000-IB	COVER, OIL FILTER MAINT(I/BLUE)	1	Y		20080307	20110630	KMYBA8BLS8C002343	KMYBA8BLS8C004032
		7	80101-BA5-0000	RUBBER, RR.FENDER CUSHION	4	N		20070425		KMYBA8BLS7C000001	
		8	90001-BA5-0000	COLLAR, SIDE MOUNT	4	Y		20070425		KMYBA8BLS7C000001	
		9	90115-CB4-0000	SCREW, FR.COVER SETTING, 5x20	4	Y		20070425		KMYBA8BLS7C000001	
		10	90192-SB1-0000	SCREW, SPECIAL, 5x12	14	Y		20070425	20080609	KMYBA8BLS7C000001	KMYBA8BLS8C002914
			90192-SB1-0000	SCREW, SPECIAL, 5x12	12	Y		20080610		KMYBA8BLS8C002915	
		11	90302-SA4-0030	NUT, SPRING, 4mm	2	Y		20080307		KMYBA8BLS8C002343	
		12	90677-SE5-0030	NUT, CLIP, 5mm	6	Y		20070425		KMYBA8BLS7C000001	
		13	90683-SE5-0030	CLIP, BODY COVER	4	Y		20070425		KMYBA8BLS7C000001	

F-33

SIDE COWL

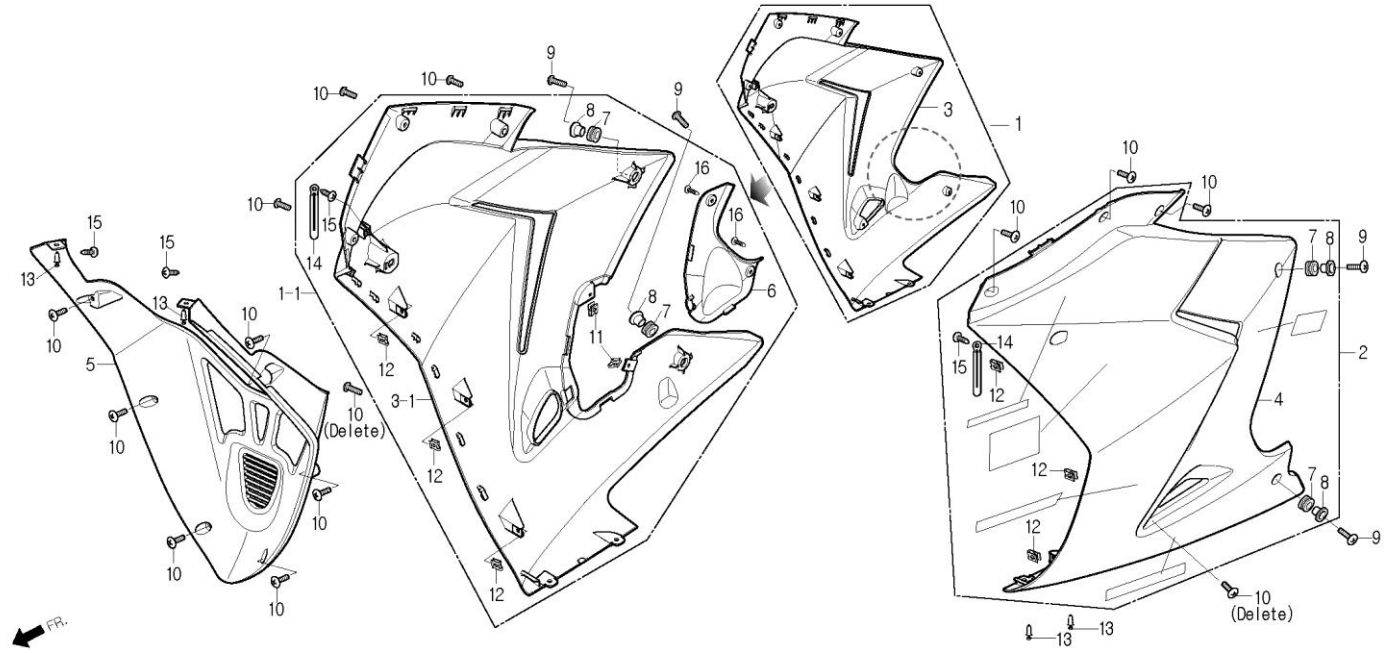

Service item	FRT	Ref No.	Part No.	Description	QTY	A/S	Exch	Start Date	End Date	Start FRM.No	End FRM.No
		14	91411-BA6-9600	CLIP, 2x90	2	Y		20070425		KMYBA8BLS7C000001	
		15	S3903-25220	SCREW, TAPPING, 5x12	4	N	Y	20070425	20100430	KMYBA8BLS7C000001	KMYBA8BLSAC003562
			S3903-25210	SCREW, TAPPING, 5x12	4	Y		20100501		KMYBA8BLSAC003563	
		16	S3903-34380	SCREW, TAPPING, 4x12	2	N		20080307		KMYBA8BLS8C002343	